

8 7 6 5 4 3 2 1

### CYLINDER DIMENSIONS

BORE	
STROKE	
ROD DIA.	
THREAD	
PITCH	
A1	
WF1	
A2	
WF2	
ZM	
GE PORT	
BE PORT	
CUSHIONED?	
E	
LD	

### L-SERIES NFPA CYLINDER DOUBLE ROD

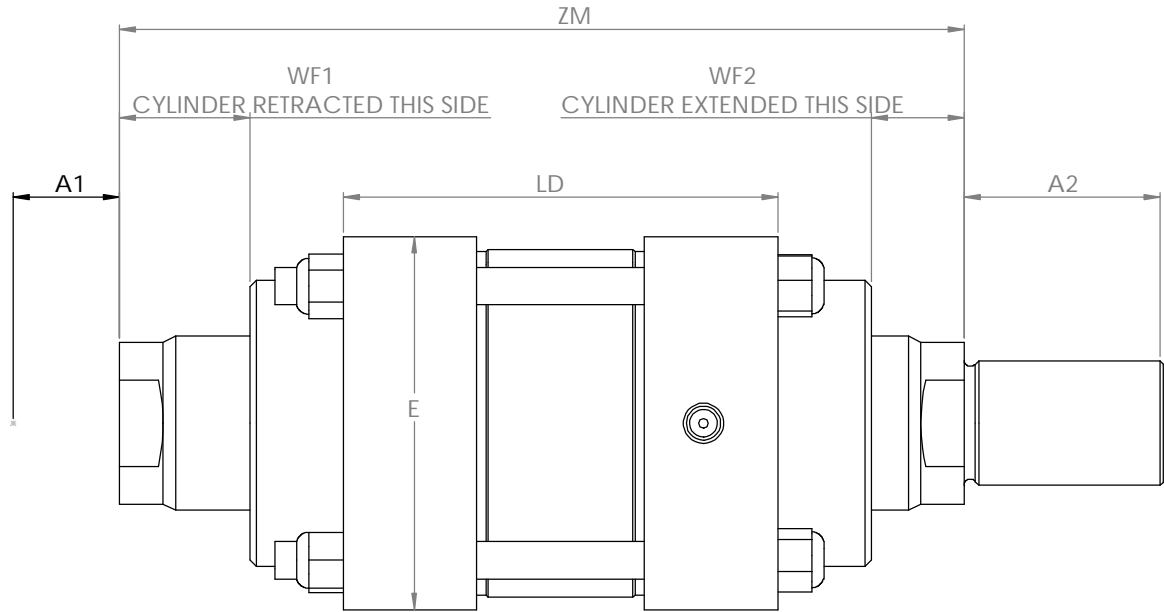

Westcoast Cylinders Inc.  
225 Edworthy Way  
New Westminster, British Columbia  
Canada, V3L 5G4

No.	DATE	REVISION	REV. BY	<p><b>PROPRIETARY AND CONFIDENTIAL WARNING</b> THE INFORMATION CONTAINED IN THIS DRAWING IS THE SOLE PROPERTY OF WESTCOAST CYLINDERS INC. ANY REPRODUCTION IN PART OR AS A WHOLE WITHOUT THE WRITTEN PERMISSION OF WESTCOAST CYLINDERS INC. IS PROHIBITED. IF YOU HAVE RECEIVED THIS DRAWING BY ERROR, PLEASE CONTACT WESTCOAST CYLINDERS INC. 1-877-637-6925 (TOLL FREE)</p>	<p>UNLESS OTHERWISE SPECIFIED: DIMENSIONS ARE IN INCHES TOLERANCES: ANGULAR: MACH ±2° TWO PLACE DECIMAL ±.01 THREE PLACE DECIMAL ±.005 SURFACE FINISH 125 ✓</p>	<p>NAME</p> <p>DRAWN</p> <p>CHECKED</p>	<p>DATE</p>	<p>TITLE:</p>	<p>DRAWING NO.</p>	<p>REV</p>
						SCALE: 1:1.25				

8 7 6 5 4 3 2 1