

L-SERIES PARTS LIST

| No. | DESCRIPTION | QTY | BORE > | | 2 | | 2 1/2 | | | 3 1/4 | | | 4 | | | 5 | | | 6 | | | |
|--------|---------------------------------|-----|-------------|----------|-------------|----------|-------------|----------|----------|------------|----------|----------|----------|----------|----------|----------|----------|----------|----------|----------|----------|----------|
| | | | 5/8 | 1 | 5/8 | 1 | 1 3/8 | 5/8 | 1 | 1 3/8 | 1 | 1 3/8 | 1 3/4 | 1 | 1 3/8 | 1 3/4 | 1 | 1 3/8 | 1 3/4 | 1 3/8 | 1 3/4 | 2 |
| 1 | PISTON | 1 | 1L15 | | 1L20 | | 1L25 | | | 1L32 | | | 1L40 | | | 1L50 | | | 1L60 | | | |
| 3 | CUSHION SLEEVE | 1 | N/A | N/A | 3L20 | N/A | N/A | 3L25 | 3L25 | 3L2513 | 3L32 | | | 3L40 | | | 3L40 | | | 3L60 | | |
| 4 | ROD - MALE | 1 | 4L1506- | 4L1510- | 4L2006- | 4L2010- | 4L2013- | 4L2506- | 4L2510- | 4L2513- | 4L3210- | 4L3213- | 4L3217- | 4L4010- | 4L4013- | 4L4017- | 4L5010- | 4L5013- | 4L5017- | 4L6013- | 4L6017- | 4L6020- |
| 26 | ROD - FEMALE | 1 | 26L1506- | 26L1510- | 26L2006- | 26L2010- | 26L2013- | 26L2506- | 26L2510- | 26L2513- | 26L3210- | 26L3213- | 26L3217- | 26L4010- | 26L4013- | 26L4017- | 26L5010- | 26L5013- | 26L5017- | 26L6013- | 26L6017- | 26L6020- |
| 44 | ROD - COMMON | 1 | 44L1506- | 44L1510- | 44L2006- | 44L2010- | 44L2013- | 44L2506- | 44L2510- | 44L2513- | 44L3210- | 44L3213- | 44L3217- | 44L4010- | 44L4013- | 44L4017- | 44L5010- | 44L5013- | 44L5017- | 44L6013- | 44L6017- | 44L6020- |
| 5 | BARREL (NITROTEC STEEL) | 1 | 5LN15- | | 5LN20- | | 5LN25- | | | 5LN32- | | | 5LN40- | | | 5LN50- | | | 5LN60- | | | |
| 5 | BARREL (CHROMIUM STEEL) | 1 | 5LSB15- | | 5LSB20- | | 5LSB25- | | | 5LSB32- | | | 5LSB40- | | | 5LSB50- | | | 5LSB60- | | | |
| 5 | BARREL (ALUMINUM) | 1 | 5LAL15- | | 5LAL20- | | 5LAL25- | | | 5LAL32- | | | 5LAL40- | | | 5LAL50- | | | 5LAL60- | | | |
| 5 | BARREL (AMALGON) | 1 | 5LAM15- | | 5LAM20- | | 5LAM25- | | | 5LAM32- | | | 5LAM40- | | | 5LAM50- | | | 5LAM60- | | | |
| 6 | GLAND BUSHING | 1 | 6L1562 | 6L1510 | 6L2062 | 6L2010 | 6L2013 | 6L2062 | 6L2010 | 6L2013 | 6L3210 | 6L3213 | 6L3217 | 6L3210 | 6L3213 | 6L3217 | 6L3210 | 6L3213 | 6L3217 | 6L6013 | 6L6017 | 6L6020 |
| ** 7 | NEEDLE VALVE | 2 | * 7L344 | | 7L344 | * 7L344 | * 7L344 | 7L344 | 7L344 | 7L344 | 7L344 | 7L344 | 7L344 | 7L344 | 7L344 | 7A912 | 7A912 | 7A912 | 7A912 | 7A912 | 7A912 | 7A912 |
| 8 | TIE ROD | 4 | 8L 154- | | 8L 205- | | 8L 255- | | | 8L 326- | | | 8L 406- | | | 8L 508- | | | 8L 608- | | | |
| 8 | TIE-ROD, MODEL LT ONLY *** | 4 | 8LTA154- | 8LTB154- | 8LTA205- | 8LTB205- | 8LTC205- | 8LTA255- | 8LTB255- | 8LTC255- | 8LTA326- | 8LTB326- | 8LTC326- | 8LTA406- | 8LTB406- | 8LTC406- | 8LTA508- | 8LTB508- | 8LTC508- | 8LTA608- | 8LTB608- | 8LTC608- |
| 9 | PISTON SEAL, INTERNAL | 1 | 9A111 | | 9A111 | | 9A111 | | | 9A210 | | | 9A211 | | | 9A211 | | | 9A216 | | | |
| ** 9 | CUSHION SLEEVE SEAL | 1 | N/A | | N/A | | N/A | | | 9A120 | | | N/A | | | N/A | | | N/A | | | |
| ** 10 | PISTON SEAL | 1 | 10A755-15 | | 10A755-2 | | 10A755-25 | | | 10A755-325 | | | 10A755-4 | | | 10A755-5 | | | 10A755-6 | | | |
| ** 11 | CHECK SEAL-GLAND END(CG or CBE) | 1 | N/A | | 11J122 | N/A | N/A | 11J132 | 11J132 | N/A | 11J150 | 11J150 | 11J150 | 11J150 | 11J150 | 11J150 | 11J150 | 11J150 | 11J150 | 11J150 | 11J150 | 11J150 |
| ** 11A | CHECK SEAL-BLIND END(CB or CBE) | 1 | 11J110 | | 11J110 | | 11J110 | | | 11J110 | | | 11J110 | | | 11J110 | | | 11J110 | | | |
| ** 12 | GLAND BUSHING SEAL | 1 | 9A123 | | 9A223 | | 9A223 | | | 9A227 | | | 9A227 | | | 9A227 | | | 9A230 | | | |
| ** 13 | ROD SEAL | 1 | 13A06H | 13J10H | 13A06H | 13J10H | 13A13H | 13A06H | 13J10H | 13A13H | 13J10H | 13A13H | 13A17H | 13J10H | 13A13H | 13A17H | 13J10H | 13A13H | 13A17H | 13A13H | 13A17H | 13J20H |
| ** 14 | ROD WIPER | 1 | 14H62 | 14H10-1 | 14H62 | 14H10 | 14H13 | 14H62 | 14H10 | 14H13 | 14H10 | 14H13 | 14H17 | 14H10 | 14H13 | 14H17 | 14H10 | 14H13 | 14H17 | 14H13 | 14H17 | 14H20 |
| 15 | GLAND BUSHING RETAINER | 1 | 15A137 | | 15A187 | | 15A187 | | | 15A237 | | | 15A237 | | | 15A237 | | | 15A275 | | | |
| ** 16 | NEEDLE VALVE SEAL | 2 | * 9A009 | | 9A009 | * 9A009 | * 9A009 | 9A009 | 9A009 | 9A009 | 9A009 | 9A009 | 9A009 | 9A009 | 9A009 | 9A009 | 9A113 | 9A113 | 9A113 | 9A113 | 9A113 | 9A113 |
| 17 | LOCK NUT - TIE ROD (BLIND END) | 4 | 19A004 | | 19A005 | | 19A005 | | | 19A006 | | | 19A006 | | | 19A006 | | | 19A008 | | | |
| 17A | LOCK NUT - TIE ROD (GLAND END) | 4 | 19D004 | | 19D005 | | 19A005 | | | 19A006 | | | 19A006 | | | 19A006 | | | 19A008 | | | |
| 19 | PISTON LOCKNUT (or NUTSPEAR) | 1 | **** 19L007 | | **** 19L007 | | **** 19L007 | | | 19J012 | | | 19J012 | | | 19J012 | | | 19J016 | | | |
| 20 | JAM NUT (OPTIONAL) | 1 | 20R007 | 20R012 | 20R007 | 20R012 | 20R016 | 20R007 | 20R012 | 20R016 | 20R012 | 20R016 | 20R020 | 20R012 | 20R016 | 20R020 | 20R012 | 20R016 | 20R020 | 20R012 | 20R016 | 20R024 |
| ** 21 | BARREL SEAL | 2 | 9A125 | | 9A224 | | 9A228 | | | 9A234 | | | 9A240 | | | 9A248 | | | 9A256 | | | |
| 22 | HEAD BLIND END | 1 | L 15BC | | L 2BC | | L 25BC | | | L 32BC | | | L 4BC | | | L 5BC | | | L 6BC | | | |
| 23 | HEAD GLAND END | 1 | L 15G | | L 2GC | L 2G | L 2G | L 25GC | L 25GC | L 25G13C | L 32GC | | | L 4GC | | | L 5GC | | | L 6GC | | |
| 24 | TRUNNION-INTERMEDIATE | 1 | LT15 | | LT20 | | LT25 | | | LT32 | | | LT40 | | | LT50 | | | LT60 | | | |
| ** 33 | CHECK BALL | 1 | N/A | | N/A | | N/A | | | 33K25 | | | N/A | | | N/A | | | N/A | | | |
| ** 35 | CHECK PLUG | 1 | N/A | | N/A | | N/A | | | 35H04 | | | N/A | | | N/A | | | N/A | | | |
| 38 | FRONT PLATE-RECTANGULAR | 1 | FP15R | | FP20R | | FP25R | | | FP32R | | | FP40R | | | FP50R | | | FP60R | | | |
| 38 | FRONT PLATE-SQUARE | 1 | FP15S | | FP20S | | FP25S | | | FP32S | | | FP40S | | | FP50S | | | FP60S | | | |
| 38 | FRONT PLATE-THICK (RECT.) | 1 | FP15RU | | FP20RU | | FP25RU | | | FP32RU | | | FP40RU | | | FP50RU | | | FP60RU | | | |
| 38 | FRONT PLATE-THICK (SQUARE) | 1 | FP15SU | | FP20SU | | FP25SU | | | FP32SU | | | FP40SU | | | FP50SU | | | FP60SU | | | |
| 38 | SPACER PLATE (model option "F") | 1 | FP15F | | FP20F | | FP25F | | | FP32F | | | FP40F | | | FP50F | | | FP60F | | | |
| 38 | BACK PLATE-RECTANGULAR | 1 | BP15R | | BP20R | | BP25R | | | BP32R | | | BP40R | | | BP50R | | | BP60R | | | |
| 38 | BACK PLATE-SQUARE | 1 | BP15S | | BP20S | | BP25S | | | BP32S | | | BP40S | | | BP50S | | | BP60S | | | |
| ** 40 | PISTON WEAR RING | 1 | 40H1525 | | 40H2037 | | 40H2537 | | | 40H323 | | | 40H4037 | | | 40H5037 | | | 40H6037 | | | |
| 42 | DETACHABLE CLEVIS - MP1 | 1 | LMP1-15 | | LMP1-2 | | LMP1-25 | | | LMP1-32 | | | LMP1-4 | | | LMP1-5 | | | LMP1-6 | | | |
| 43 | DETACHABLE CLEVIS - MP2 | 1 | LMP2-15 | | LMP2-2 | | LMP2-25 | | | LMP2-32 | | | LMP2-4 | | | LMP2-5 | | | LMP2-6 | | | |
| | SEAL KIT (PNEUMATIC) | 1 | KL1562A | KL1510A | KL2062A | KL2010A | KL2013A | KL2562A | KL2510A | KL2513A | KL3210A | KL3213A | KL3217A | KL4010A | KL4013A | KL4017A | KL5010A | KL5013A | KL5017A | KL6013A | KL6017A | KL6020A |

NOTES:

Cushioning is supplied as standard on all cylinders unless ordered otherwise.

A part no. having an underscore indicates a model letter code is required. See tables below.

Parts for a non-cushioned cylinder are the same as for cushioned except the check seals are not installed. For the 2 1/2" bore, 1 3/8" rod cylinder on the blind end, remove the check seal; on the gland end remove the cushion sleeve and cushion sleeve seal.

Part numbers terminating in a dash must have the stroke value added immediately afterward.

* Contact the factory for cushioning options on the gland end of the 1 1/2" bore (both rod sizes), and the 2" bore (1" and 1 3/8" only rod sizes). For these cylinders, the quantity of needle valves and needle valve seals must be halved.

** These parts are in the seal kit.

*** Tie-rod part numbers for model LT only have a stroke value suffix followed by a dash and then the required "XI" value (see explanation following).

**** If cylinder is specified as non cushioned then supply 19J007 for piston lock nut.

HEAD PART NOS. ARE MADE AS FOLLOWS:

- SERIES - "L"
 - Use table (to right) to select head mounting style.
 - BORE eg 3-1/4" bore use 32, 4" bore use 4.
 - LOCATION; B=Blind G=Gland or Rod end.
 - CUSHIONED = "C"
- (All heads are manufactured as cushioned.)

| CYLINDER MODEL | GLAND HEAD | BLIND HEAD |
|----------------|------------|------------|
| LC | C | C |
| LE | C | E |
| LD | C | n/a |
| LB | C | R |
| LBS | C | R |
| LR | C | R |
| LRS | C | R |
| LNW/A/B/C | C | R |
| LTR | T | R |
| LTB | C | T |
| LT | C | R |
| LF | F | F |
| LG | RSH | RSH |
| LH | BSH | BSH |
| LW | C | W |
| LMP | C | R |

eg. Cyl. Model "LRS", 3-1/4" Bore, Cushioned
Gland end head "LC32GC"
Blind end head "LR32BC"

ROD PART NUMBER STRUCTURE:

- COMPONENT No - "4"
- SERIES - "L"
- THE CYLINDER BORE eg 3-1/4" bore use 32, 4" bore use 40
- ROD SIZE; 2 digits long as follows: eg. 1-3/4" rod = 17, 1" rod = 10, 5/8" rod = 06
- OPTIONS: "CC"=CC thread, "FT"=Full thread, "F"=Female thread, "U"=Rod Extension for thicker Mtg. Flange Plate(LR and LRS only), "T"=Rod End Trunnion, "TB" = Blind End Trunnion, "D"= Male Rod of Double-Rod cylinder, "S"= Side-tapped Mount.
- STROKE VALUE. (to be preceded by a dash "-"). eg. 7" stroke..."-7"

eg. 3-1/4" bore 1-3/8" rod, 8" stroke; "4L3213-8"
eg. 4" bore 1" rod, CC thread, 8" stroke; "4L4010CC-8"
Note: all piston rods are made cushioned.

TIE-ROD PART NUMBER STRUCTURE:

- COMPONENT No. - "8"
- SERIES - "L"
- CYL. MODEL - use table (to right) to select letter code
Note, some cyl. models use a common code.
- ROD SIZE - FOR LT MODEL ONLY: "A", "B" or "C"
A = R1 Rod size, B = R2, and C = Rod 3.
- CYLINDER BORE (2 digits) ie. 20 = 2" bore
- TIE-ROD DIA. in 16ths of an inch
ie. 5 = 5/16" 12 = 3/4"
- STROKE VALUE, preceded by a dash
- XI DIMENSION, preceded by a dash. For Models LT only.

eg. 4" bore, model LTB, 12" stroke; 8LF406-12
eg. 2 1/2" bore, model LT, 1 3/8" rod (R3), 8" stroke, XI = 5"; 8LTC255-8,5
Note: for LT models the two-piece tie-rods are sold as a unit (one half may be a capscrew, depending on trunnion position).
Note: if there is a Piston Rod Extension, the XI value in the Tie-Rod Part Number is reduced equally. For the above example with a 1" Rod Extn, 8LTC255-8,5 would become 8LTC255-8,4

| CYLINDER MODELS | LETTER CODE |
|-----------------|-------------|
| LNA | A |
| LNB,LNC | B |
| LC,LE,LW | C |
| LD | D |
| LF,LTR,LTB,LNM | F |
| LCH | H |
| LMP,LB,LBS | P |
| LR,LRS | R |
| LT | T |

L-Series Parts Drawing

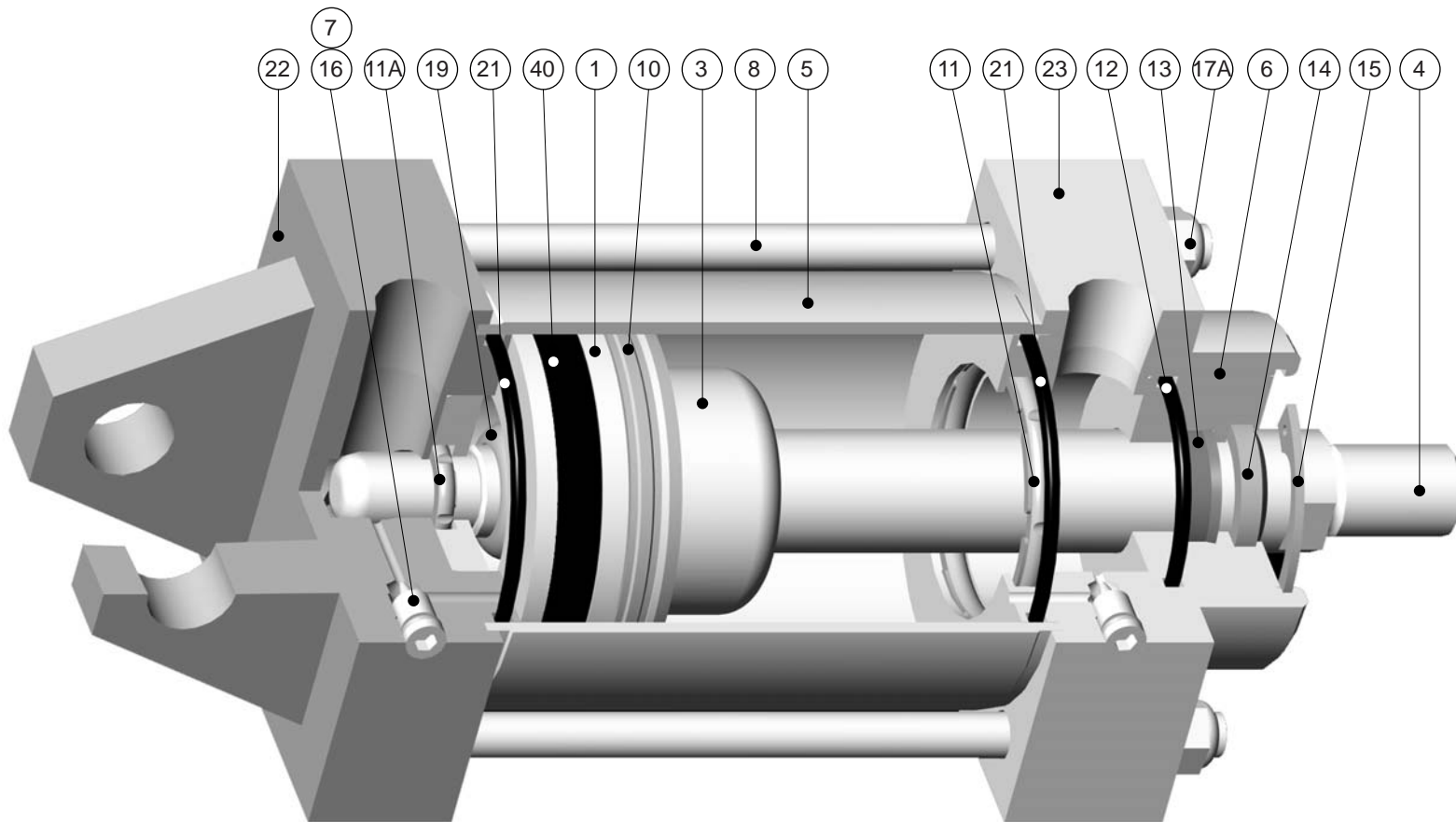



L-SERIES PARTS LIST

| | | BORE > | | 8 | | | 10 | | | 12 | | |
|--------|---------------------------------|------------|-----------|-----------|-----------|------------|------------|------------|------------|------------|------------|---|
| | | ROD SIZE > | | 1 3/8 | 1 3/4 | 2 | 1 3/4 | 2 | 2 1/2 | 2 | 2 1/2 | 3 |
| No. | DESCRIPTION | QTY | | | | | | | | | | |
| 1 | PISTON | 1 | 1L80 | | | 1L100 | | | 1L120 | | | |
| 3 | CUSHION SLEEVE | 1 | 3L80 | | | 3L100 | | | 3L120 | | | |
| 4 | ROD - MALE | 1 | 4L8013- | 4L8017- | 4L8020- | 4L10017- | 4L10020- | 4L10025- | 4L12020- | 4L12025- | 4L12030- | |
| 26 | ROD - FEMALE | 1 | 26L8013- | 26L8017- | 26L8020- | 26L10017- | 26L10020- | 26L10025- | 26L12020- | 26L12025- | 26L12030- | |
| 44 | ROD - COMMON | 1 | 44L8013- | 44L8017- | 44L8020- | 44L10017- | 44L10020- | 44L10025- | 44L12020- | 44L12025- | 44L12030- | |
| 5 | BARREL (NITROTEC STEEL) | 1 | 5LN80- | | | 5LN100- | | | 5LN120- | | | |
| 5 | BARREL (CHROMED STEEL) | 1 | 5LSB80- | | | 5LSB100- | | | 5LSB120- | | | |
| 5 | BARREL (ALUMINUM) | 1 | 5LAL80- | | | 5LAL100- | | | 5LAL120- | | | |
| 5 | BARREL (AMALGON) | 1 | 5LAM80- | | | 5LAM100- | | | 5LAM120- | | | |
| 6 | GLAND BUSHING | 1 | 6L8013 | 6L8017 | 6L8020 | 6L10017 | 6L10020 | 6L10025 | 6L12020 | 6L12025 | 6L12030 | |
| ** 7 | NEEDLE VALVE | 2 | 7A912 | | | 7A916 | | | 7A916 | | | |
| 8 | TIE ROD | 4 | 8L 8010- | | | 8L 10012- | | | 8L 12012- | | | |
| 8 | TIE-ROD, MODEL LT ONLY *** | 4 | 8LTA8010- | 8LTB8010- | 8LTC8010- | 8LTA10012- | 8LTB10012- | 8LTC10012- | 8LTA12012- | 8LTB12012- | 8LTC12012- | |
| 9 | PISTON SEAL, INTERNAL | 1 | 9A216 | | | 9A220 | | | 9A223 | | | |
| ** 10 | PISTON SEAL | 2 | 10A980H | | | 10A9100H | | | 10A9120H | | | |
| ** 11 | CHECK SEAL-GLAND END(CG or CBE) | 1 | 11J170 | | | 11J1100 | | | 11J1100 | | | |
| ** 11A | CHECK SEAL-BLIND END(CB or CBE) | 1 | 11J122 | | | 11J128 | | | 11J132 | | | |
| ** 12 | GLAND BUSHING SEAL | 1 | 9A236 | | | 9A242 | | | 9A245 | | | |
| ** 13 | ROD SEAL | 1 | 13A13H | 13A17H | 13J20H | 13A17H | 13J20H | 13J25H | 13J20H | 13J25H | 13J30H | |
| ** 14 | ROD WIPER | 1 | 14H13 | 14H17 | 14H20 | 14H17 | 14H20 | 14H25 | 14H20 | 14H25 | 14H30 | |
| ** 16 | NEEDLE VALVE SEAL | 2 | 9A113 | | | 9A210 | | | 9A210 | | | |
| 17 | LOCK NUT - TIE ROD | 8 | 19A010 | | | 19A012 | | | 19A012 | | | |
| 19 | PISTON LOCKNUT | 1 | 19J016 | | | 19H020 | | | 19J024 | | | |
| 20 | JAM NUT (OPTIONAL) | 1 | 20R016 | 20R020 | 20R024 | 20R020 | 20R024 | 20R030 | 20R024 | 20R030 | 20R036 | |
| ** 21 | BARREL SEAL | 2 | 9A265 | | | 9A273 | | | 9A452 | | | |
| 22 | HEAD BLIND END | 1 | L 8BC | | | L 10BC | | | L 12BC | | | |
| 23 | HEAD GLAND END | 1 | L 8GC | | | L 10GC | | | L 12GC | | | |
| 24 | TRUNNION-INTERMEDIATE | 1 | LT80 | | | LT100 | | | LT120 | | | |
| 25 | CAPSCREW (GLAND BUSH. RETAINER) | 4 | 25A1007 | | | 25A1008 | | | 25A1008 | | | |
| 27 | LOCKWASHER (GL. BUSH. RETAINER) | 4 | 9972 | | | 9972 | | | 9972 | | | |
| 38 | GLAND BUSHING RETAINER | 1 | 38L8 | | | 38L10 | | | 38L12 | | | |
| ** 40 | PISTON WEAR RING | 1 | 40H8037 | | | 40H107 | | | 40H127 | | | |
| | SEAL KIT (PNEUMATIC) | 1 | KL8013A | KL8017A | KL8020A | KL10017A | KL10020A | KL10025A | KL1220A | KL1225A | KL1230A | |

NOTES:

Cushioning is supplied as standard on all cylinders unless ordered otherwise.

A part no. having an underscore indicates a model letter code is required. See tables below.

Parts for a non-cushioned cylinder are the same as for cushioned except the check seals are not installed. For the 2 1/2" bore, 1 3/8" rod cylinder on the blind end, remove the check seal; on the gland end remove the cushion sleeve.

Part numbers terminating in a dash must have the stroke value added immediately afterward.

* Contact the factory for cushioning options on the gland end of the 1 1/2" bore (both rod sizes), and the 2" bore (1" and 1 3/8" only rod sizes). For these cylinders, the quantity of needle valves and needle valve seals must be halved.

** These parts are in the seal kit.

*** Tie-rod part numbers for model LT only have a stroke value suffix followed by a dash and then the required "Xl" value (see explanation following).

HEAD PART NUMBER STRUCTURE:

- SERIES - "L"
- Use table (to right) to select head mounting style.
- BORE eg 3-1/4" bore use 32, 4" bore use 4.
- LOCATION; B=Blind G=Gland or Rod end.
- CUSHIONED = "C"
(All heads are manufactured as cushioned.)

eg. Cyl. Model "LRS", 3-1/4" Bore, Cushioned
Gland end head "LC32GC"
Blind end head "LR32BC"

| CYLINDER MODEL | GLAND HEAD | BLIND HEAD |
|----------------|------------|------------|
| LC | C | C |
| LE | C | E |
| LD | C | n/a |
| LB | C | R |
| LBS | C | R |
| LR | C | R |
| LRS | C | R |
| LNMA/B/C | C | R |
| LTR | T | R |
| LTB | C | T |
| LT | C | R |
| LF | F | F |
| LG | RSH | RSH |
| LH | BSH | BSH |
| LW | C | W |
| LMP | C | R |

ROD PART NUMBER STRUCTURE:

- COMPONENT No. - "4"
- SERIES - "L"
- THE CYLINDER BORE eg 3-1/4" bore use 32, 4" bore use 40
- ROD SIZE; 2 digits long as follows:
eg. 1-3/4" rod = 17, 1" rod = 10, 5/8" rod = 06
- OPTIONS: "CC"=CC thread, "FT"=Full thread, "F"=Female thread, "U"=Rod Extension for thicker Mtg. Flange Plate(LR and LRS only)
- STROKE VALUE, (to be preceded by a dash "-").
eg. 7 "stroke" - 7"

eg. 3-1/4" bore 1-3/8" rod, 8" stroke; "4L3213-8"
eg. 4" bore 1" rod, CC thread, 8" stroke; "4L4010CC-8"
Note: all piston rods are made cushioned.

TIE-ROD PART NUMBER STRUCTURE:

- COMPONENT No. - "8"
- SERIES - "L"
- CYL. MODEL - use table (to right) to select letter code
Note, some cyl. models use a common code.
- ROD SIZE - FOR LT MODEL ONLY: "A", "B" or "C"
A = R1 Rod size, B = R2, and C = Rod 3.
- CYLINDER BORE (2 digits) ie. 20 = 2" bore
- TIE-ROD DIA. in 16ths of an inch
ie. 5 = 5/16" 12 = 3/4"
- STROKE VALUE, preceded by a dash
- XI DIMENSION, preceded by a dash. For Models LT only.
eg. 4" bore, model LTB, 12" stroke; 8LF406-12

eg. 2 1/2" bore, model LT, 1 3/8" rod (R3), 8" stroke, XI = 5"; 8LTC255-8,5
Note: for LT models the two-piece tie-rods are sold as a unit (one half may be a cap screw, depending on trunnion position).
Note: if there is a Piston Rod Extension, the XI value in the Tie-Rod Part Number is reduced equally. For the above example with a 1" Rod Extn, 8LTC255-8,5 would become 8LTC255-8,4

CYLINDER PRESSURE TABLE

| BORE | AIR | HYDRAULIC | |
|-------|-----|------------------|------------------------|
| | | ALL EXCEPT LB,LR | HYDRAULIC MODELS LB,LR |
| 1 1/2 | 250 | 1500 | 750 |
| 2 | 250 | 1500 | 500 |
| 2 1/2 | 250 | 1000 | 300 |
| 3 1/4 | 250 | 1000 | 400 |
| 4 | 250 | 900 | 350 |
| 5 | 250 | 700 | 350 |
| 6 | 250 | 600 | 250 |
| 8 | 250 | 600 | - |
| 10 | 250 | 600 | - |
| 12 | 250 | 500 | - |

| CYLINDER MODELS | LETTER CODE |
|-----------------|-------------|
| LNA | A |
| LNB,LNC | B |
| LC,LE,LW | C |
| LD | D |
| LF,LTR,LTB,LNM | F |
| LCH | H |
| LMP,LB,LBS | P |
| LR,LRS | R |
| LT | T |